

FL--ENM

Monobloc gears pump

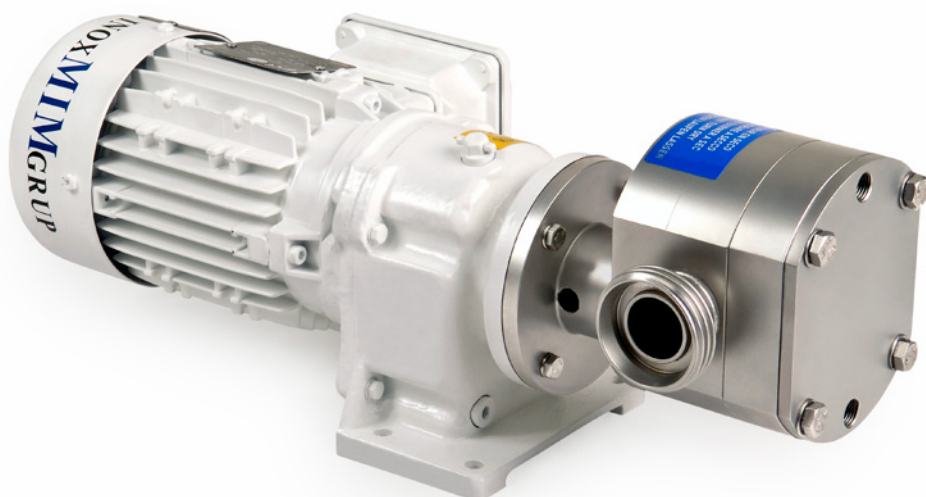

FL--ENM external gear pumps are robust, reliable machines which provide a precise, constant flow. This characteristic is very useful in a wide range of applications.

They can be applied in operations such as: dosing of anchovy paste, oils, fats, creams, chocolates and other products.

OPERATING PRINCIPLE

Movement of the product comes from the flow of the liquid between the teeth of two coupled gears. The main gear (driving gear) is moved by the motor shaft and forces the follower gear (free gear) to turn; this volume displacement is proportional to the turning speed and provides the required flow equally in both directions.

This pump is highly recommended for dosing and transferring high viscosity products, along with other products which need to be handled at controlled temperature, thanks to the option of including a heating chamber in the front in order to prevent solidification or crystallization.

CHARACTERISTICS

- Reversible
- High performance and capability to work with high temperatures
- Low noise level
- Long life in extreme working conditions
- High versatility and reliability
- Completely watertight
- Monobloc design and compact size
- DIN 11851 connections

MATERIALS

- Teflon follower gear
- Driving gear in SS AISI 316
- Parts in contact with the product are made of SS AISI 316
- Level of finish: Foodstuff

OPTIONS

- Control panel
- Heating chamber through electrical elements, steam or hot water
- Pressure control device with pressure switch
- Temperature control device with temperature probes
- Iron/stainless steel trolley, platform
- CE control panel with start/stop device, inverter, 10 m of wire, electrical connectors
- Other connections: FLANGE, BSP, CLAMP, RJT, etc.

CAPACITY OF FL--ENC PUMPS

MODEL	Min. Flow (L/h)	Max. Flow (L/h)	Max. Pressure (bar)	DIN 11851	BSP	CLAMP
FL40ENM	200	1.000	2	DN25 - DN32	1" - 1¼"	1" - 1¼"
FL60ENM	400	2.000	2	DN25 - DN32	1" - 1¼"	1" - 1¼"

DIMENSIONS OF FL--ENM MODEL

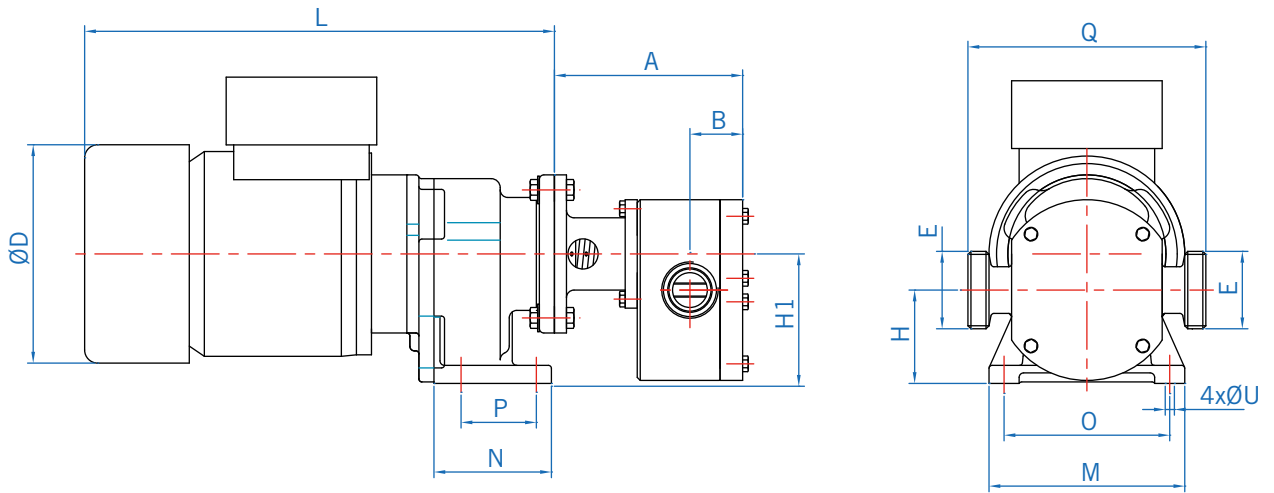

MODEL	A	B	D	E	H	H1	L	M	N	O	P	Q	U
FL40ENM	125	35	130	DN25 - DN32	62	86	290	130	78	110	50	158	8.5
FL60ENM	165	45	145	DN25 - DN32	62	86	312	130	78	110	50	158	8.5

